



**SURGICALLY CLEAN AIR**

**ELECTRONIC AIR PURIFIER**



OPERATIONAL MANUAL

Model No. SCA4000R



- WARNING: • This unit cannot be used in an atmosphere containing Explosive dust, gas or oxygen, or in an area where flammable dust is present.
- This product can be used only where the power supply is 120V/60Hz.
  - You cannot use the unit if the power voltage is different.

## Surgically Clean Air Inc.

3451 Lake Shore Blvd. W.

Toronto, ON M8W 1N2

Tel: 1-877-440-7770

Fax: 1-416-503-9563

[www.surgicallycleanair.com](http://www.surgicallycleanair.com)

[info@surgicallycleanair.com](mailto:info@surgicallycleanair.com)

## TABLE OF CONTENTS

FOR CUSTOMER ASSISTANCE

CONSUMER LIMITED WARRANTY

CHAPTER 1 IMPORTANT SAFETY PRECAUTIONS

CHAPTER 2 HOW IT WORKS

CHAPTER 3 PART NUMBER AND NAME

Part Names

Part Numbers

CHAPTER 4 FEATURES AND SPECIFICATIONS

Features

Product Specifications

CHAPTER 5 OPERATION

Main Unit Operation

Setting New Functions

Remote Control Operation

CHAPTER 6 CARE AND MAINTENANCE

Cleaning the Pre-filter

Cleaning the Electronic Cell

Replacing the Activated Carbon Filter

Photo catalytic Filter and UV Lamps

CHAPTER 7 FREQUENTLY ASKED QUESTIONS (FAQs)

Why Does My Air Purifier Spark?

How Should I Clean the Cell?

How Often Should I Change the  
Activated Carbon Filter (Charcoal Filter)?

CHAPTER 8 TROUBLESHOOTING

The Unit Does not Operate

When Functions Do not Work

Automatic Function Does not Work Properly

When Other Problems in Terms of Functions Are Found

CHAPTER 9 ELECTRICAL WIRING DIAGRAM

SERVICE REMINDER SCHEDULE

## FOR CUSTOMER ASSISTANCE

If you have any questions about your air purifier, call the customer service number. Before calling, please note the model and serial number located on the back of the unit and fill in the following information below. This information will help us answer your questions much more quickly.

Model number

---

Serial number

---

Date of purchase

---

Dealer name

---

Address

---

City

---

Province

---

Postal code

---

Telephone

---

Phone: 1-877-440-7770

Write: For service problems, guarantee information, missing items and other assistance:

Surgically Clean Air Inc.

3451 Lake Shore Blvd. W. Toronto, ON M8W 1N2

Tel: 1-877-440-7770

Fax: 1-416-503-9563

Please provide the following information when you write or call: model number, serial number, date of purchase, your complete mailing address (including Postal Code), your daytime telephone number (including area code) and description of the problem.

## CONSUMER LIMITED WARRANTY

### SURGICALLY CLEAN AIR ELECTRONIC AIR PURIFIER LIMITED WARRANTY

Congratulations on your investment

Surgically Clean Air Inc. (Hereinafter called SCA) gives you the following limited warranty for this product only if it was originally purchased from SCA or from an Authorized SCA Dealer.

SCA warrants that this product is free, under normal use and maintenance, from any defects in material and workmanship. If any such defects should be found in this product within the applicable warranty period, SCA shall, at its option, repair or replace the product as specified herein.

SCA will repair or replace, free of charge, to the original purchaser, any part that is found to be defective in material or workmanship within one (1) year of the date of purchase. This limited warranty does not cover the replacement of expendable or consumable parts such as filters, and other parts subject to normal wear unless they are defective in material or workmanship.

This warranty shall not apply if:

- Any defects caused or repairs required because of abusive operation, negligence, accident, improper installation or inappropriate use as outlined in the operation manual.
- Any product tampered with modified, adjusted or repaired by any party other than SCA, SCA Authorized Service Centers or SCA Authorized Service Dealers.
- Damage caused or repairs required because of the use with items not specified or approved by SCA.
- Any damage caused by external or environmental conditions, including but not limited to the use of voltage other than indicated on the product.

SCA's limited warranty is valid only if you retain proof of purchase from SCA or a SCA Authorized Retail Dealer for this product.

To obtain the name and address of the nearest Authorized SCA Dealers, please contact:  
Surgically Clean Air at  
3451 Lake Shore Blvd. W. Toronto, ON M8W 1N2

For more information on this Warranty, Dealers or Service Locations, please call 1-877-440-7770

Visit our website: [www.surgicallycleanair.com](http://www.surgicallycleanair.com)

**CHAPTER 1**  
**IMPORTANT SAFETY PRECAUTIONS**

TO REDUCE THE RISK OF ELECTRICAL SHOCK, FIRE OR INJURY TO PERSON(S) READ THE FOLLOWING:

Power Cord	<ul style="list-style-type: none"><li>• Use only as described in this manual.</li><li>• Use only a 120-volt outlet with grounding wire receptacle.</li><li>• Do not use the air purifier if the power cord or plug is damaged or the connection to the wall outlet is loose.</li><li>• When removing the power plug, always hold the plug and never pull by the cord.</li><li>• Do not handle plug or appliance with wet hands. Electrical shock or fire from short circuit may occur.</li><li>• Remove the power plug from the wall outlet before cleaning the unit and when not using the unit. Turn off all controls before unplugging.</li><li>• If the power cord is damaged, it must be replaced by the RespirAide authorized service or similarly qualified person.</li><li>• To reduce the risk of electric shock, this equipment has a grounding type plug that has a third (grounding) pin. This plug will only fit into a grounding type power outlet. If the plug does not fit into the outlet, contact qualified personnel to install the proper outlet. Do not alter the plug in any way.</li></ul>
Unit Operation	<ul style="list-style-type: none"><li>• Do not use the unit in an enclosed space where oxygen, flammable, explosive or toxic vapors are given off by oil base paint, paint thinner, some mothproofing substances, or in an area where flammable dust is present.</li><li>• Do not clean outside with paint thinner or any chemicals. If so, the unit surface may become damaged or may cause fire.</li><li>• Do not wash or reuse the activated carbon filter.</li><li>• Do not operate the unit without filters.</li><li>• Do not insert fingers or foreign objects into the intake or air outlet.</li><li>• Keep hair, loose clothing, fingers and all parts of body away from openings and moving parts.</li><li>• Do not block the intake and air outlet.</li><li>• Do not use the unit near or on hot objects, such as range or where it may be exposed to steam.</li><li>• Always hold the handles on the side of the unit when moving it. Holding the front panel when carrying may cause it to detach, and result in bodily harm.</li><li>• Be careful not to tip over the unit when opening the front panel. If not, it may cause bodily harm.</li><li>• The batteries must be removed from the remote control before disposal, and the batteries must be disposed of safely.</li></ul>

## CHAPTER 1 IMPORTANT SAFETY PRECAUTIONS

This manual classifies precautions into WARNINGS and CAUTIONS. Be sure to follow all precautions below: They are important for ensuring your safety.

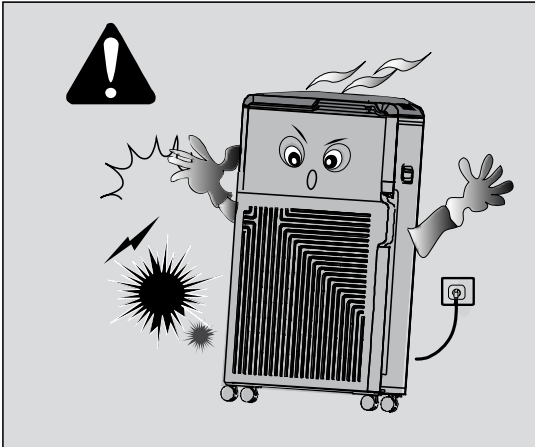

1. This unit cannot be used in an atmosphere containing explosive dust, gas or in an area where flammable substances are present. If so, it results in explosion or fire!

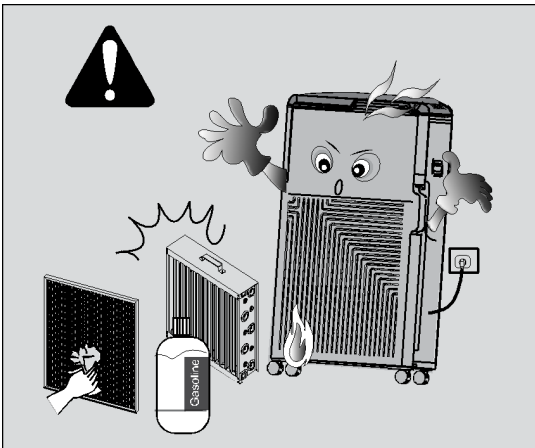

2. Do not clean the unit or any parts (e.g. pre-filter, electronic cell or activated carbon filter etc.) with alcohol, gasoline, paint thinner or other flammable substances. It may cause fire!

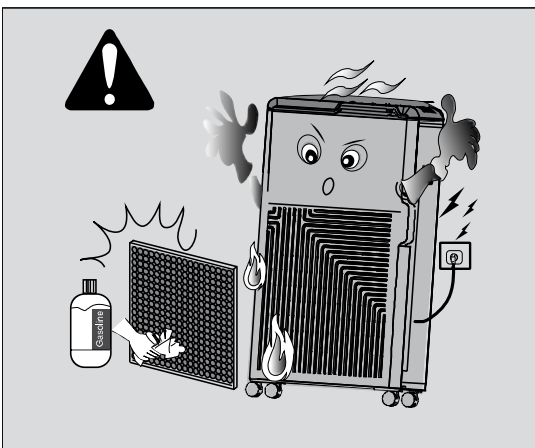

3. Do not wash or reuse the activated carbon filter or clean the activated carbon filter with liquid, especially alcohol, gasoline, paint thinner, etc... It may cause fire!

### WARNING:

If you do not follow these instructions exactly, the unit may cause property damage, personal injury or loss of life.

### WARNING:

- Do not use the unit in the places containing explosive dust, gas or flammable substances.
- Do not cleanse the unit or any parts with flammable substances.
- Do not wash or reuse the activated carbon filter.

**CHAPTER 1**  
**IMPORTANT SAFET PRECAUTIONS**

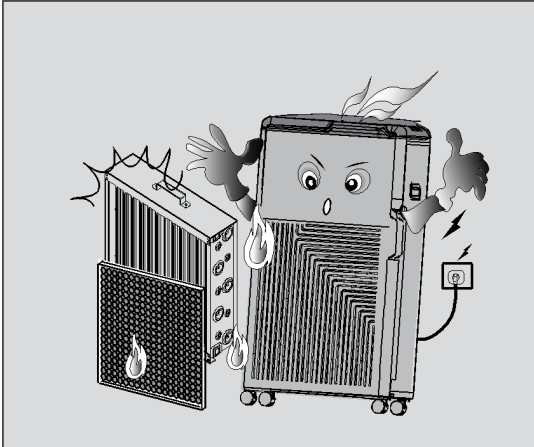

4. The activated carbon filter must be located behind the cell. Do not try to place the activated carbon filter in front of the cell. It may cause fire!

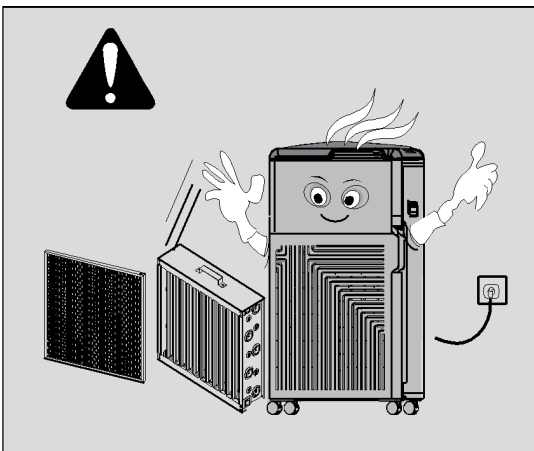

5. After cleaning the filters, make sure to dry them thoroughly before reinstalling. Failure to do so may cause the unit to stop working or personal injury.

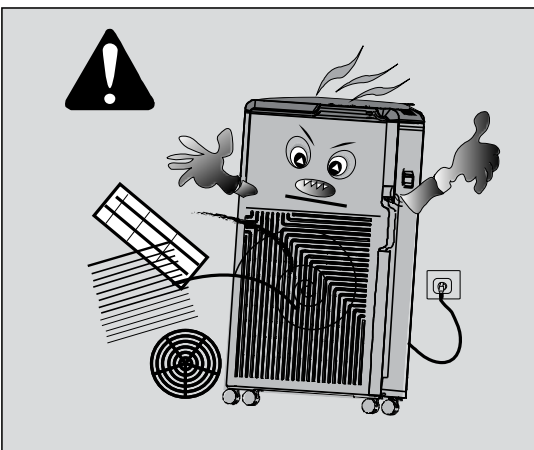

6. Do not disassemble or modify this equipment. Unwarranted tampering can lead to fire, electric shock and unit malfunction.

**WARNING:**

If you do not follow these instructions exactly, the unit may cause property damage, personal injury or loss of life.

**WARNING:**

- Do not try to place the activated carbon filter in front of the cell.
- Dry the cell and Pre filter thoroughly after cleaning.
- Do not disassemble or modify the unit.

## CHAPTER 1 IMPORTANT SAFETY PRECAUTIONS

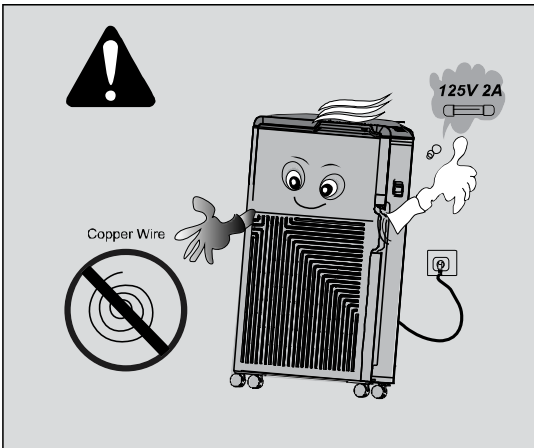

7. Use a fuse with proper capacity. Never use a wire in place of a fuse.  
Doing this may lead to malfunction or fire.

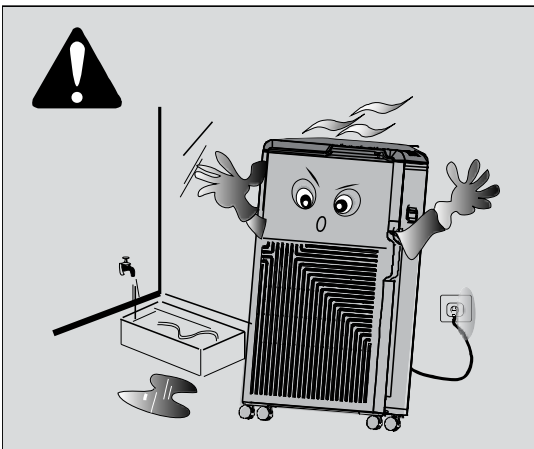

8. Do not use the unit in humid places that might be wet.  
Contact with water can lead to electric shock or damage the equipment.

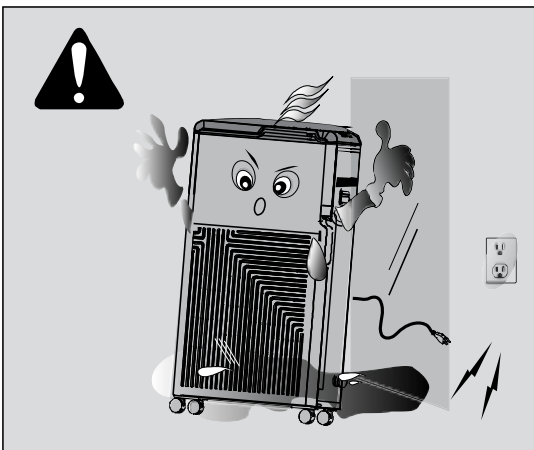

9. If any parts of the power source get wet remove the plug and dry them completely before reusing.

### WARNING:

If you do not follow these instructions exactly, the unit may cause property damage, personal injury or loss of life.

### WARNING:

- Do not use the unit in humid places that might be wet.
- Do not place the product in direct contact with sunlight.

## CHAPTER 1

### IMPORTANT SAFETY PRECAUTIONS

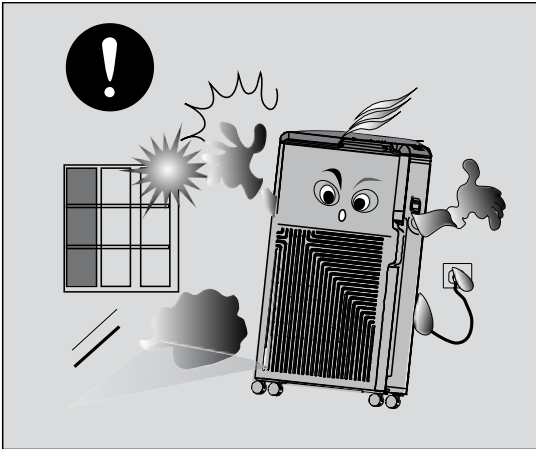

1. Do not place the product in direct contact with sunlight. It may cause malfunction and deformation of the product.

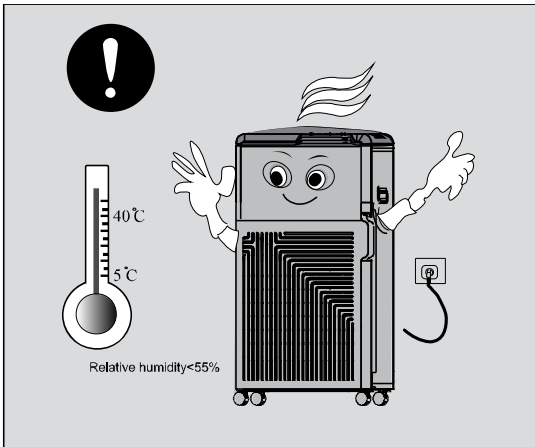

2. Do not use the unit in high humidity conditions. Use the product in the ambient temperature of 0-40°C.

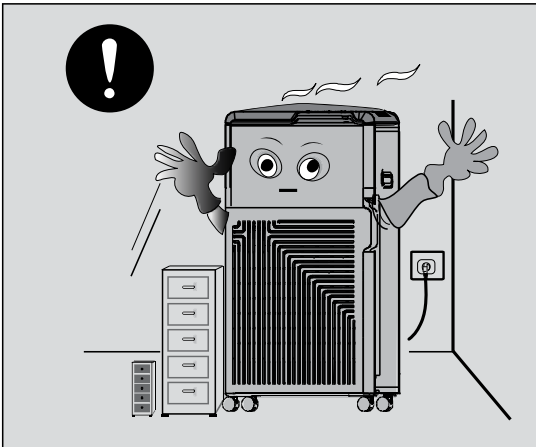

3. Do not block the intake or outlet. Blocked openings can reduce capacity or damage the unit.

#### CAUTION

If you do not follow these instructions exactly, the unit may cause minor property damage or personal injury.

## CHAPTER 2

### HOW IT WORKS

The air purifier functions as an air cleaner by helping to disinfect airborne microorganisms and removing particulates from the air.

The centrifugal fans of the unit draw air through the front panel (Intake) on the front of the unit. Then it passes through the Pre-filter, the electronic cell, the activated carbon filter and the UV-Photo catalytic sterilization chamber. The purified air is then released through the outlet on the top of the unit.

The air is cleansed in six stages:

- The Pre-filter traps large dust particles.
- The two-stage electrostatic precipitator captures airborne particles. In the ionizing section of the electronic cell, billions of microscopic particles become electrically charged as they pass through the powerful electric field. The collector plates immediately attract and collect these charged dust and dirt particles.
- The activated carbon filter adsorbs and reduces odors, chemicals and gases, removes tobacco smoke, the smell of food and other odors.
- The UV sterilization chamber kills bacteria and viral microorganisms such as influenza, TB and Legionnaire's Disease as well as other harmful contaminants.
- When UV light hits the photo catalytic filter, it creates e<sup>-</sup> and h<sup>+</sup>, which have an excellent effect in the decomposition of odors.
- The unit also generates negative ions that freshens the room air.

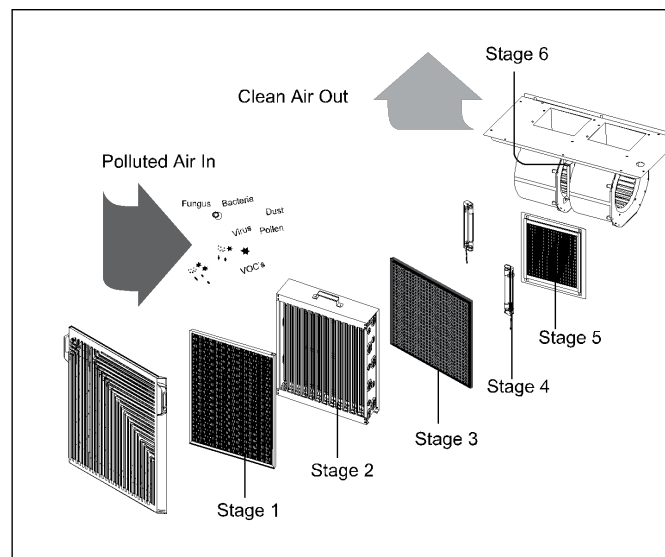

Part Name

Stage 1 Pre-filter

Stage 2 Electronic Cell

Stage 3 Activated Carbon Filter

Stage 4 UV-C Germicidal Lamp

Stage 5 Photo catalyst

Stage 6 Negative Ion Generators

## CHAPTER 3 PART NUMBER AND NAME

### Part Numbers

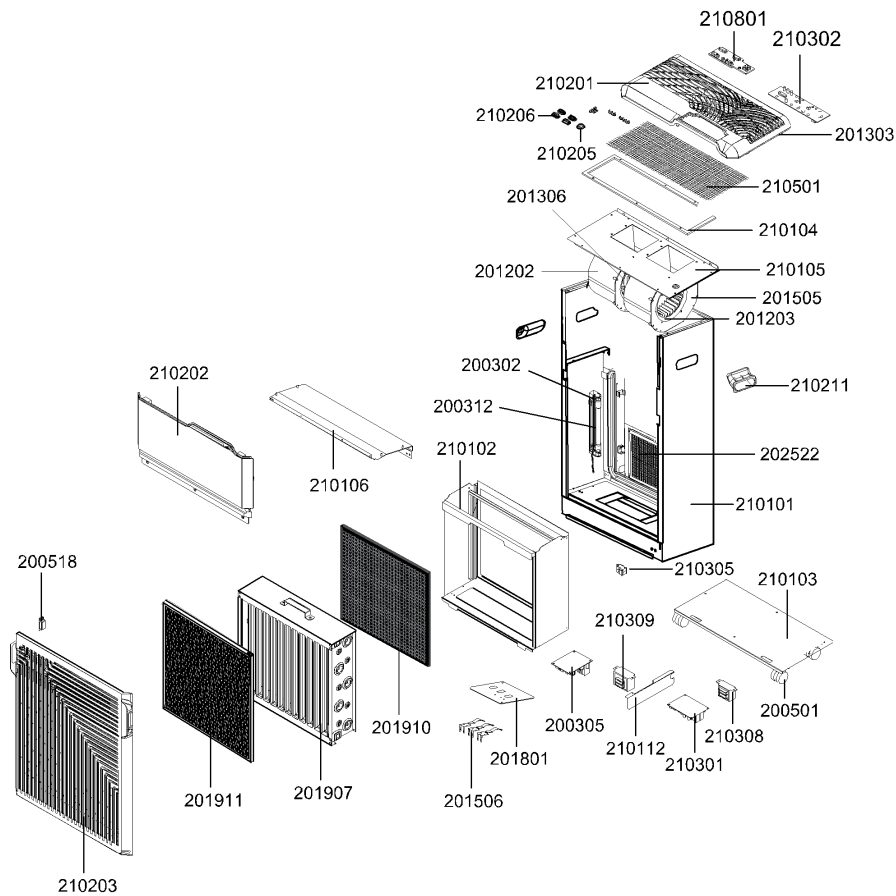

### Part Names

210203 Plastic front panel	210101 Unit housing
200518 Front panel magnet	200312 UV lamp
201911 Pre-filter	200302 UV lamp holder & ballast
201907 Electronic cell	202522 Photo catalyst
201910 Activated carbon filter	210211 Unit Handle
210102 Filter case	21306 Fan Motor
210202 Upper panel	21202 Fan housing
210106 Fan motor bottom plate	21203 Fan blade
201506 Unit power contact plate	201505 Fan motor side plate
201801 Unit epoxy resin board	210105 Fan motor top plate
200305 Power supply	210104 Outlet screen holder
210309 Power supply transformer	210501 Outlet screen
210112 Circuit board protector	210201 Plastic top cover
210301 Main circuit board	210302 Display circuit board
210308 Main circuit board transformer	21303 Odor sensor
200501 Caster	210801 Silica gel button lining
210103 Bottom plate	210205 Power button-square type
210305 Interlock switch	210206 Button-rectangle type

## CHAPTER 4

### FEATURES AND SPECIFICATIONS

#### Product Specifications Multi-Stage Filters

The unit utilizes a two-stage electrostatic precipitator (Electronic cell) combined with a Pre-filter (For large particles), an Activated carbon filter (For odors and gases), UV germicidal light (Killing airborne pathogen), a Photo catalytic filter (Removes VOC's) and a Negative ion generator.

#### Automatic Function

The odor sensor automatically selects the appropriate fan speed depending on the air quality detected.

#### Carbon Filter, UV Lamps Replacement and Cell Cleaning Indicator Lights

The REPLACE CARBON FILTER, REPLACE UV LAMPS indicator lights tell you when to replace the activated carbon filter or the UV lamps.

Also, the CLEAN CELL indicator light tells you when to clean the electronic cell.

#### Safety Micro-Switch (Interlock switch)

This air purifier is equipped with a safety interlock switch (Micro-safety switch) that will turn the unit off if the front panel is opened while the unit is running.

#### Easy Maintenance and Low Cost

When the electronic cell needs to be washed or the filters need to be replaced, simply open the front panel and pull out the electronic cell or old filters and put the new or clean one in.

No screws, hooks or tools are required. The electronic cell captures small particles on aluminum plates that are simply rinsed off in the sink.

#### Specifications

Model No.	SCA4000R
Power Requirement	120V, 60Hz, 1A
Rated Power	96W
Fan Motor	120V, 60Hz
Noise Level	<55dB
Negative Ion	$3 \times 10^6 / \text{cm}^3$
UV Lamp	6Wx2
Dimensions	H83.5cmxW47.8cmxD23.8cm
Weight	23.8kg

#### Standby Power

In order to operate the electrical circuits while the power plug is inserted in the wall outlet, this product consumes about 5.8W of standby power. For energy conservation, unplug the power cord when the unit is not in use.

## CHAPTER 5 OPERATION

### Main Unit Operation

#### Connect the Power

Plug the unit into an electric outlet, the unit will be ready to run and all the indicators on the display panel will light up for 2 seconds.

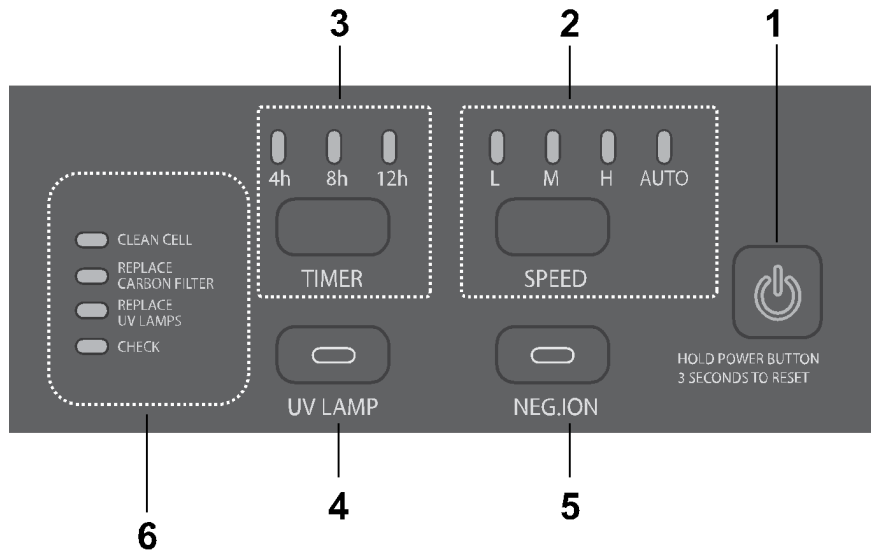

#### 1. POWER Button

Press the POWER button to start the unit, re-press it to stop. The unit will run at low speed when the POWER button is pressed.

#### 2. SPEED Button

When the power is on, the unit will be set at the L speed and the indicator lights will illuminate, select the speed by pressing the SPEED button. Each time the SPEED button is pressed the airflow rate changes as shown below:

L ----- M ----- H ----- AUTO----- L...

#### 3. TIMER Button

When the TIMER button is pressed, the indicator light will light up. The indicator light shows the set time. Press the TIMER button to select the time for operation. The unit will automatically turn off once the timer has counted down to zero.

#### 4. UV LAMP Button

When the UV LAMP button is pressed, it will turn off the UV lamps, pressing again will turn on the UV lights. The indicator light will light up when the UV lights are on.

#### 5. NEG.ION Button

When pressed, the generation of ions will cease and the negative ion generator light on the button will go out.

#### 6. INDICATOR Lights

- CLEAN CELL indicator light- When the CLEAN CELL indicator light flashes, the cell needs to be washed.
- REPLACE CARBON FILTER indicator light  
When the REPLACE CARBON FILTER indicator light flashes, the activated carbon filter needs to be replaced.

- UV LAMP indicator light

If the REPLACE UV LAMPS flashes, it tells the time for the UV lamps to be replaced.

- CHECK indicator light

When the indicator light flashes red with beeping, please contact customer service.

POWER Button:

- When the power cord is connected to the electrical outlet, the indicator light will light up yellow and pressing the POWER button to start the unit and it will turn white in color.
- Hold the Power button down 3 seconds to RESET the indicator lights after CLEANING CELL, REPLACING THE CARBON FILTER and THE UV LAMPS.

AUTO Mode:

Every time the power plug is inserted into the wall outlet, the auto sensor needs a short warming up period. During this time, the SPEED indicator lights flash, moving from L to H.

## CHAPTER 5 OPERATION

### Setting new functions

The unit buttons offers access to a number of functions:

#### 1. Timer Cycle Function

Setp1. Power off the unit.

Step2. Hold the TIMER button for 3 seconds until the "8 hour" indicator light comes on.

Step3. Press the TIMER button one time and wait for all the timer lights flash.

Step4. Press the POWER button.

Step5. Press the POWER button to operate the unit.

Step6. Press the TIMER button again. This time all the indicator lights will be on.

In this case the unit will start to work 2 hours and stops 2 hours automatically

If you want to return to the default mode, do the reverse.

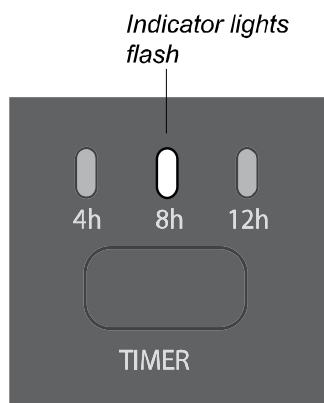

5-1 Default mode

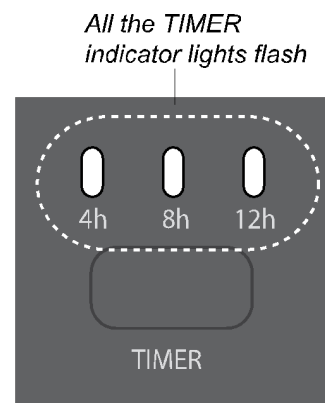

5-2 Timer cycle mode

#### 2. Cell Clean Dry Function

- Stop the unit operation and hold down the SPEED button until you hear a beep sound to set up the Cell Clean Dry function mode.
- In this mode, the unit electronic cell does not charge for 45 minutes allowing time to dry the cell.
- After running 45 minutes, the cell will automatically charge and start to work.

#### 3. Change the Button Melody

- Stop the unit operation and hold down the UV LAMP and NEG. ION buttons at the same time until you hear the new melody.
- If you want to go back to the default melody, do the reverse.

Note: This function is helpful for drying the cell thoroughly after cleaning.

## CHAPTER 5 OPERATION

### Remote Control Operation

The battery is already set in the remote control; pull out the clear sheet from the battery cover before using.

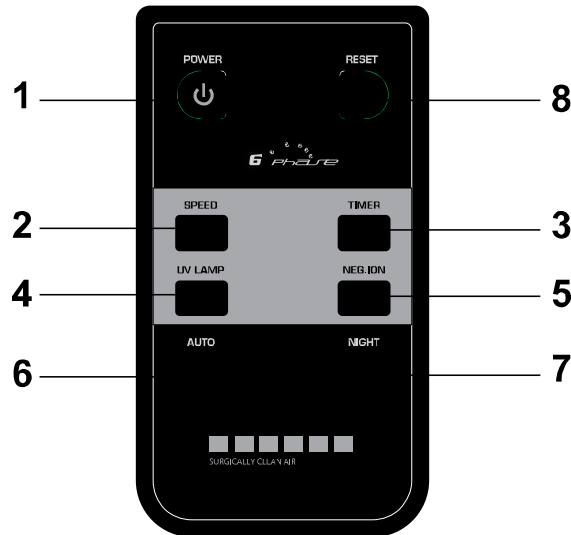

#### 1. POWER Button

The unit will start operating when the POWER button is pressed. Pressing the button again will stop operation.

#### 2. SPEED Button

The fan speed can be switched among Low, Medium and High settings.

#### 3. TIMER Button

The set time switches every time when the button is pressed as shown below:

L ----- M ----- H ----- AUTO----- L...

#### 4. UV LAMP Button

When pressed, turn off the UV lamp.

#### 5. NEG.ION Button

When pressed, the generation of ions will cease and the negative ion generator light on the control panel will go out.

#### 6. AUTO Button

In Auto mode, the fan speed is automatically switched (L and M) depending on the amount of pollution in the air.

#### 7. NIGHT Button

When pressed, all the indicators will go out except the POWER button light on the control panel.

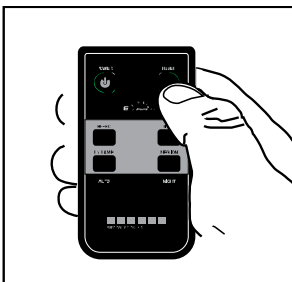

#### 8. RESET Button

After the replacement of activated carbon filter or the UV lamp, make sure to press RESET button 3 times to reset the timer. After cleaning the electronic cell, press the RESET button 3 times to reset the cell cleaning time.

Note: Before pressing the RESET button, be sure the unit is plugged in.

### Remote Control Operation



Pull out the clear sheet from the battery cover before using.

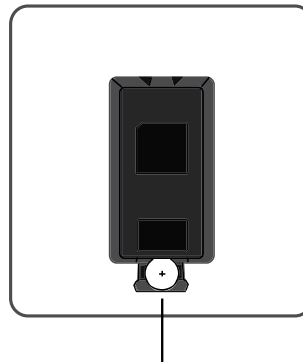

CR2025 Battery

### Battery Information

- Open the cover on the rear of the remote control towards the arrow.
- Replace the battery with CR2025 battery. Be sure to set the battery with the (+) side up.
- Close the cover to its original position.
- The battery for this remote control is for initial use only.  
Change the battery when necessary.
- When not using the unit or remote control for an extended period, remove the battery.

## CHAPTER 6

### CARE AND MAINTENANCE

To maintain optimum performance of this air purifier, please clean the unit including the Pre-filter and electronic cell periodically. When cleaning the unit, be sure to unplug the power cord, and never handle the plug with wet hands. If so, electrical shock and bodily injury may occur as a result.

#### Main Unit

To prevent dirt or stains on the main unit, clean as often as necessary. If stains are allowed to remain, they may become difficult to remove. Wipe with a dry, soft cloth for stubborn stains or dirt, use a soft cloth dampened with warm water. Do not use volatile fluids, Benzene, paint thinner, polishing powder, this may damage the surface. Do not use detergents, detergent ingredients may damage the unit. Keep the unit away from water.

#### Cleaning the Pre-filter

To assure optimum performance the Pre-filter should be cleaned regularly-every one to two weeks. Washing frequency will vary depending on the number of family members, pets, activities (such as cooking or woodworking) and smoking habits. Use the wash reminder schedule in this manual.

- Stop the operation and unplug the unit.
- Open the front panel.
- Pull the Pre-filter straight up and out of the front panel.
- After using a vacuum cleaner to remove any dust, clean with water. If it is very dirty, use a soft brush or a neutral cleaner to clean then dry completely before placing it back into the unit.
- Place the Pre-filter back into the front panel by sliding straight down into the slots.



6-1 Open the front panel



6-2 Removing the Pre-filter

#### WARNING:

Cleaning the unit while it is plugged in may result electric shock, electric spark and serious injury. Unplug the unit before cleaning or maintenance!

#### WARNING:

- DO NOT clean the Pre-filter with flammable substances (Alcohol, gasoline, paint thinner, etc.). It may cause fire!
- After cleaning the Pre- filter, it is very important to dry it completely before placing it back in the unit.
- During maintenance, be careful not to tip over the unit. It may cause personal injury.

## CHAPTER 6

### CARE AND MAINTENANCE

#### Cleaning the Electronic Cell

Remove the electronic cell

- Stop the operation and unplug the unit.
- Please wait 5-10 seconds before taking off the front panel.
- Pull the cell straight up and out of the filter cabinet.



6-3 Open the front panel



6-4 Removing the cell

- If the CLEAN CELL indicator lights flashes, it is the time to clean the cell.
- If the air quality is extremely poor and the cell is dirty, you may clean the cell before CLEAN CELL indicator light flashes.

How to clean the electronic cell

- To assure optimum performance the cell should be cleaned every one to two months.
- Use a large enough container, such as a laundry tub or trash container.  
Dissolve detergent in warm water to cover the cell. After the detergent has completely dissolved, place the cell in the container. Allow the cell to soak for 15~30 minutes and rinse with clean water. Tough residue such as tar from tobacco smoke may need longer soaking.
- After cleaning, make sure to rinse detergent residue thoroughly out of the ceramic insulators of the cell. Dry the cell thoroughly with heat gun before reinstalling.

Reset the CLEAN CELL indicator light

After sliding the clean cell in the unit, hold the POWER button down on the control panel 3 seconds or press the RESET button on the remote control 3 times to reset the CLEAN CELL indicator light.

#### Helpful Hints

The electronic cell stops powering up for 45 minutes every time you clean the cell and reset the CLEAN CELL indicator light.

**WARNING:**

- DO NOT clean the cell with alcohol, gasoline, paint thinner or other flammable substances.  
It may cause fire!
- DO NOT reinstall the cell until it is completely dry. If the CHECK light flashes red, then the cell may still be wet.

- Be sure there is no detergent residue around the cell ceramic insulators, especially around the square shape ceramic insulators.
- Slide in the cell so the airflow arrow points toward the machine.



Reset the CLEAN CELL indicator light

- Hold the POWER button down on the control panel 3 seconds to reset the CLEAN CELL indicator light.

## CHAPTER 6

### CARE AND MAINTENANCE

#### Replacing the Activated Carbon Filter

When the REPLACE CARBON FILTER indicator light flashes, the activated carbon filter needs to be replaced.

- Stop the operation and unplug the unit.
- Please wait 5-10 seconds before opening the front panel.
- Remove the old activated carbon filter from the filter cabinet and insert a new one.



6-5 Replace the activated carbon filter.

If the air quality is extremely poor, you may replace the activated carbon filter before the REPLACE CARBON FILTER indicator light flashes. The activated carbon filter is located behind the electronic cell.

Reset the REPLACE CARBON FILTER indicator light

After replacing the activated carbon filter, hold the POWER button down on the control panel 3 seconds or press the RESET button on the remote control 3 times to reset the indicator light.

#### Photo catalytic Filter and UV Lamps

##### Photo catalytic filter

Photo catalytic filter is permanent, never needs replacing. When there is dust on it, clean the dust off using a vacuum cleaner dusting brush. Do not wash it in water.

##### UV lamps

- When the REPLACE UV LAMPS indicator light on the control panel flashes, it is time to replace the UV lamps.
- Removing the UV light blocker, gently rotate the lamp a quarter turn in either direction until it unlocks from the socket.



#### 6-6 Replace the UV Lamps

After removing the UV light blocker, rotate the lamp to unlock it from the socket.

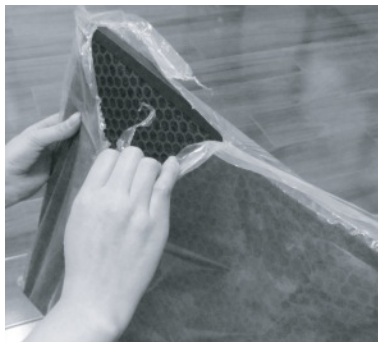

Note:

Remove plastic packaging from the activated carbon filter before operation.

**WARNING:**

- DO NOT reuse or clean the activated carbon filter with liquid, especially alcohol, gasoline, paint thinner, etc. It may cause fire!
- DO NOT try to place the activated carbon filter in front of the cell! It may cause fire!

**WARNING:**

- Never look directly at UV lamp.
- Direct exposure to germicidal light can cause temporary or chronic damage to your eyesight, or even blindness.
- Always unplug the unit before cleaning, servicing or replacing the UV lamp.

## CHAPTER 7

### FREQUENTLY ASKED QUESTIONS (FAQs)

Why does my air purifier spark?

It is common for the purifier to spark, crackle or pop during operation. A spark indicates that the air purifier captured a large air particle. If the unit sparks continuously:

- The electronic cell may be excessively dirty or have a foreign object lodged between the plates. Remove the cell from the unit and wash thoroughly.
- Visually inspect the cell for any foreign debris lodged between the plates. Also, inspect for broken ionizing wires, chipped or cracked ceramic insulators, or bent plates.
- When replacing cell in the unit, make sure the directional arrow on the cell points toward the unit.

How should I clean the cell?

- Stop the operation and unplug the unit.
- Please wait 5-10 seconds before opening the front panel.
- To assure optimum performance the cell should be cleaned every one to two months.
- Use a large enough container, such as a laundry tub or trash container.  
Dissolve detergent in warm water to cover the cell. After the detergent has completely dissolved, place the cell in the container. Allow the cell to soak for 15~30 minutes and rinse with clean water. Tough residue such as tar from tobacco smoke may need longer soaking.
- After cleaning, make sure to rinse detergent residue thoroughly out of the ceramic insulators of the cell. Dry the cell thoroughly with heat gun before reinstalling.

Important Note:

It is very important that the cell is allowed to dry completely before sliding them back into the cell cabinet as electricity is passed through the cell.

How often should I change the activated carbon filter (Charcoal filter)?

The function of the activated carbon filter is to adsorb odors and freshen the air. When the REPLACE CARBON FILTER indicator light on the control panel flashes, you should replace the activated carbon filter.

Even before the indicator light flashes you can replace the activated carbon filter using your best judgment based on the odors you perceive in your home.

**CHAPTER 8**  
**TROUBLESHOOTING**

Service problems that appear to be major can often be solved easily.

You can be your own troubleshooter by reviewing the following guide. All other servicing should be done by a SCA authorized service center.

The unit does not operate	Power failure?	Check other electrical appliances.
	Power plug disconnected?	Make sure to insert the plug.
	Is the fuse burnt?	Replace the FUSE with new one.
	Front panel open or interlock switch failure?	Te unit does not operate when the front panel is detached. Install properly. Check interlock switch.
	Is the CHECK light flashing?	The cell may be wet after cleaning. Dry it thoroughly. If not, call the Customer Service.
When functions do not work	There is too much dust on the Pre-filter, activated carbon filter?	Clean the filters or replace them.
	There is too much dust on the electronic cell?	Wash it and dry completely before reinstalling it.
	The air inlet or outlet blocked?	Get rid of foreign materials around the outlets.
Automatic function does not work properly	There is too much dust on the sensor?	Clean the dust on the sensor.
	There is no dust on the sensor.	Call the Customer Service.

When other problems in terms of functions are found

Check the problems first and then unplug the power cord. Call the Customer Service to ask for after-sale service or make inquiries.

# CHAPTER 9

## ELECTRICAL WIRING DIAGRAM

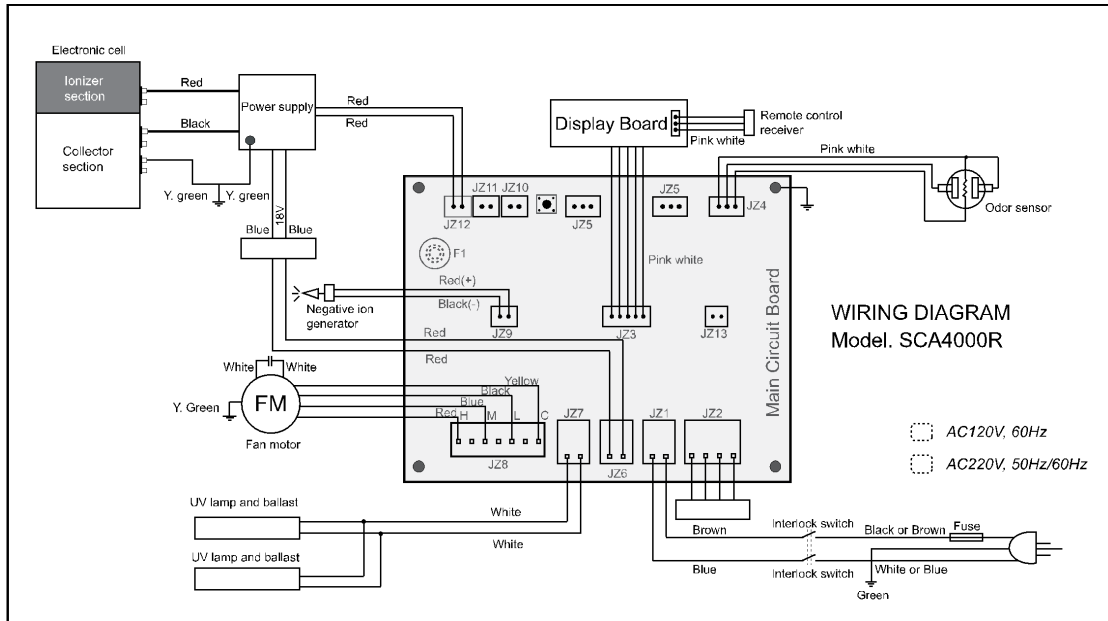

# SERVICE REMINDER SCHEDULE

## Pre-filter Wash Reminder

Year	<i>J</i>	<i>F</i>	<i>M</i>	<i>A</i>	<i>M</i>	<i>J</i>	<i>J</i>	<i>A</i>	<i>S</i>	<i>O</i>	<i>N</i>	<i>D</i>

Memo:

## Electronic Cell Wash Reminder

Year	<i>J</i>	<i>F</i>	<i>M</i>	<i>A</i>	<i>M</i>	<i>J</i>	<i>J</i>	<i>A</i>	<i>S</i>	<i>O</i>	<i>N</i>	<i>D</i>

Memo:

**Surgically Clean Air Inc.3451 Lake Shore Blvd. W.**

Toronto, ON M8W 1N2

Tel: 1-877-440-7770

Fax: 1-416-503-9563

[www.surgicallycleanair.com](http://www.surgicallycleanair.com)

[info@surgicallycleanair.com](mailto:info@surgicallycleanair.com)

SCA reserves the right to revise or modify products and/or specifications without notice. The contents of this manual are subject to change without notice.

SCA4000R-01